

TECHNICAL DATASHEET



REDUCED TEE 90°

03 Update - 04/2024

TECHNICAL DATA

Article No	001 115 0042 0318
d1 (mm)	315
d2 (mm)	225
L (mm)	712
le1 (mm)	156
le2 (mm)	125
Z (mm)	320
s1 (mm)	18,7
s2 (mm)	13,4
Weight (Kg)	17,220
Box Quantity (pcs)	1
Box Dimension (pcs)	53,5x73,5x36

IDENTIFICATION OF PRODUCT

D(mm)	315-225
SDR	17
RAW METARIAL	PE 100
PRESSURE CLASS	10 Bar Water 6 Bar Gas
TRADEMARK	NTG
EXECUTION	Injection Moulded
STANDARD	EN 12201-3 EN 1555-3 AS /NZS 4129

INJECTION MOULDED

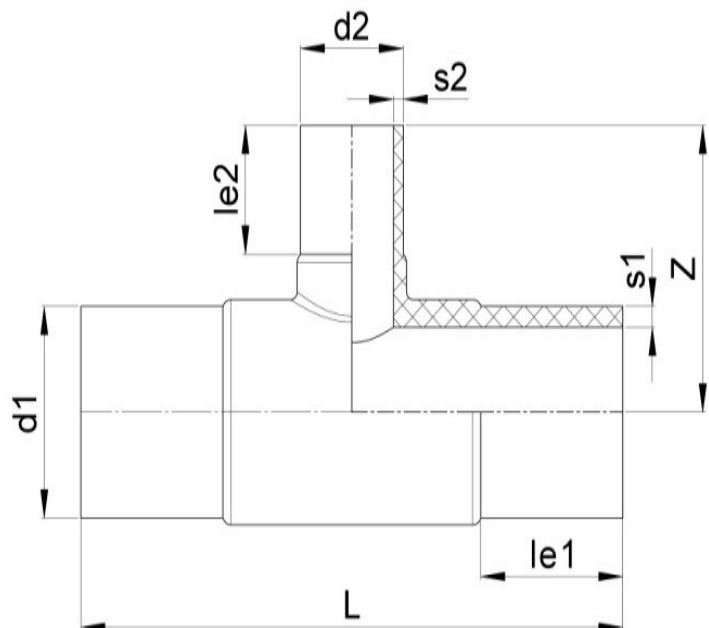

SPECIFICATION

Long Spigot

Tolerance on diameters and thickness according to the standards. The other dimensions are specialized. Tolerance $\pm 5\%$. NTG PLASTIK reserves all the right to change any information without giving prior notice. The production, distribution and utilization of this document without explicit authorization is prohibited.